



Meeting Agenda
City of Mora, Park Board
6:00 p.m. Tuesday, March 12, 2024
Mora City Hall

Mora City Hall
101 Lake Street S
Mora, MN 55051
Kanabec County,
Minnesota

City of Mora Code of Ordinances, Chapter 32:17 Duties: The Park Board shall have the duty of advising the City Council concerning the operation, maintenance, control, and planning for all of the lands, properties and facilities now owned or hereafter acquired by the city for park and recreation areas.

1. Call to Order

2. Roll Call: Kyle Sheppard Alison Holland Steven Holcombe
 Sam Pioske Curt Sammann

3. Adopt Agenda *(No item of business shall be considered unless it appears on the agenda for the meeting. Board members may add items to the agenda prior to adoption of the agenda.)*

4. Minutes

- a. Approve minutes from January 9, 2024.

5. Open Forum

(Individuals may address the committee about any item not contained on the regular agenda. There is a maximum of (15) minutes set aside for open forum. A maximum of (3) minutes is allotted per person. The Park Board will take no official action on the items discussed at the forum, with the exception of referral to staff for future report.)

6. New Business

- a. none

7. Old Business

- a. Accessibility and Inclusive Playground
b. Prioritize Park Board Projects

8. Reports/Communications

(In addition to the items listed below, each board and staff member will be given the opportunity to share information.)

9. Adjournment

The next meeting of the Park Board is scheduled for **6:00 p.m. Tuesday April 9, 2024**

**City of Mora, MN
PARK BOARD
Meeting Minutes**

January 9, 2024

Present: Steven Holcombe, Alison Holland, Sam Pioske, Curt Sammann, Kyle Shepard
Absent: None
Staff Present: City Administrator Glenn Anderson, Public Works Director Joe Kohlgraf,
Activities and Recreation Coordinator Jeff Krie

1. Call to Order. Chair Pioske called the meeting to order at 6:00 p.m.
2. Oath of Office: Sam Pioske pledged the Oath of Office for a 3-year term expiring December 21, 2026.
3. Roll Call. All present.
4. Adopt Agenda. Motion by Shepard, second by Holland to adopt the January 9, 2024 meeting agenda as presented. All present voted aye. Motion carried.
5. Minutes. Motion by Holcombe, second by Shepard to approve the November 14, 2023 meeting minutes as presented. All present voted aye. Motion carried.
6. Election of Officers. Motion made by Holland to elect Sam Pioske as Chair and Steven Holcombe as Vice Chair, second by Shepard. All present voted aye. Motion carried.
7. Open Forum. No one showed up to speak at the open forum.
8. New Business.
 - a. Music in the Park 2024: Krie shared the proposed 2024 Music in the Park schedule pending grant approval.
9. Old Business.
 - a. Accessibility and Inclusive Playground: Krie shared current information from Elizabeth Marsh on who she has done presentations with, on a quote given by playground vendor Flagship, and submitted questions she has for the board. One of her main questions was location possibilities. Staff and the board had a good first discussion and shared many possible locations that are City owned and some locations that were not. Restroom availability and controls were also discussed. No consensus was given, and the item was tabled until more information could be made available.

10. Reports.

- a. Kohlgraf: Keeping two portions of the trails free of snow down by the dog park. With the warmer weather parks still being used so doing monthly checks on the parks. Reviewing amenities at the dog park for the upcoming season. Suggested might be time for the Park Board to have a priority list of projects this board would like to see working towards.
- b. Holcombe: None
- c. Holland: None
- d. Pioske: None
- e. Sammann: None
- f. Krie: Fox Run Grant dropped, and the City would partner with SEH in preparation of the grant. Received a donation of \$8500 to go towards the resurfacing of the tennis/pickleball/basketball courts from First Citizens Bank that will be submitted for approval to City Council on January 16, 2024. MAC Schedule for 2024 and will be presented to Council for approval. Library incident cause library to close early Friday evening and all-day Saturday and all rentals were cancelled as precaution. Also, a new librarian starting for the Mora Library. Staff has a meeting scheduled for possibility of a multi-use recreational trail along or near the railroad from Mora, through Quamba, to Pine County and eventually connecting with the Mower trail in Winckley.
- g. Sheppard: Shared and asked the board to consider the possibility for a machine for renting Kayaks from Whatever Water Sports, that could be a possibility considered for Library Park. The machine cost \$7000 but Kayaks are extra cost. Trails doing good.

11. Adjournment. Motion by Sheppard, second by Holcombe to adjourn the meeting. All present voted aye. Meeting adjourned at 4:40 p.m.

Sam Pioske, Chair

Jeff Krie, Secretary

UNIVERSALLY ACCESSIBLE PLAYGROUND IN MORA

We are advocating for a universally designed, sensory-rich playground that enables children to develop physically, socially and emotionally in Mora.

Key features of an accessible playground include:

Accessible sidewalks/trails to get to and from the playground
accessible parking lots.

Poured ground cover that is easy to navigate and accessible for walkers, wheelchairs and individuals with mobility problems.

Wheelchair ramps to access equipment.

Sensory, tactile and sound areas.

Slides that do not interfere with cochlear implants.

Accessible bathrooms with adult changing stations.

A fence to enclose the playground. A fence is crucial in keeping all children safe especially children who elope.

An accessible playground not only meets the needs of individuals that have disabilities but encourages inclusive play and is beneficial for all children whether they have a disability or not.

CONTACT US

inclusiveplaygroundformora@gmail.com

Elizabeth.Jansen43@gmail.com

<https://bit.ly/3RH0zyA>



© 2021 Inclusive Playground Formora. All rights reserved. This document is for informational purposes only and does not constitute an offer of any services. Inclusive Playground Formora is not responsible for any damages or losses resulting from the use of this document.

WHAT DOES AN ACCESSIBLE PLAYGROUND LOOK LIKE?

Some key features of an accessible playground include:

- Accessible sidewalks/trails to get to and from the playground and accessible parking lots.
- Poured ground cover that is easy to navigate and accessible for walkers, wheelchairs and individuals with mobility problems.
- Wheelchair ramps to access equipment. Something to do when you get up the ramp.
- Sensory, tactile and braille areas.
- Slides that do not interfere with cochlear implants.
- Accessible bathrooms with adult changing stations.
- A fence to enclose the playground. A fence is crucial in keeping all children safe especially children who elope.

The Americans with Disabilities Act (ADA) became law in 1990. The ADA is a civil rights law that prohibits discrimination against individuals with disabilities in all areas of public life, including jobs, schools, transportation, and all public and private places that are open to the general public.

Currently, none of the parks in Mora are fully accessible.

MINNESOTA DISABILITY STATISTICS

The Study titled Minnesotans with Disabilities: Demographic and Economic Characteristics state that across Minnesota about 6.700 people have one or more disabilities. Which is roughly 12% of the population.

According to the Minnesota Education Statistics Summary for 2021-2022 school year the Department of Education reported there were 871,189 students enrolled in K-12. There were 27,801 home schooled students. Of those students there were 147,254 students receiving special education services.

KANABEC COUNTY AND SURROUNDING COUNTIES

#of individuals w/disabilities in Kanabec and neighboring counties

County Name	People with a disability	% with Disability
Kanabec	2,450	15.4%
Mille lacs	3770	14.8%
Aitkin	2880	18.9%
Pine	4260	15.3 %
Chisago	5930	11.3 %
Isanti	4370	11.5%

This information was taken from the Minnesota State Demographic Center Population Notes titled Minnesotans with Disabilities: Demographic and Economic Characteristics dated March 2017.

ACCESSIBLE PLAYGROUND LOCATIONS IN MINNESOTA

Our families represent just a small fraction of the community that would benefit from an accessible playground.

The closest accessible public playground to Mora is in St. Cloud, Minnesota.

Apple Valley (S.F. No. 1668) and Fridley (S.F. No. 2830) are the most recent cities to have bonding bills passed in the last session for accessible playground funding.

Many accessible playgrounds in Minnesota lack fencing so they are not inclusive to all needs.

There is a new playground in Ogilvie. However it isn't fully inclusive and accessible.

Minnesota Accessible Playgrounds

Accessible playgrounds are places that are safe for children with disabilities. They include features for children with physical and developmental disabilities, such as wheelchair accessible paths, sensory stimulating equipment, and safety features like a secure fence. Look for the universal symbol for accessibility. Some playgrounds also have equipment for adaptive sports.

- | | | | |
|--|------------------------------------|------------------------------------|------------------------------------|
| Apple Valley
1668
Apple Valley, MN 56105 | Chaska
2830
Chaska, MN 56002 | Chaska
2830
Chaska, MN 56002 | Chaska
2830
Chaska, MN 56002 |
| Apple Valley
1668
Apple Valley, MN 56105 | Chaska
2830
Chaska, MN 56002 | Chaska
2830
Chaska, MN 56002 | Chaska
2830
Chaska, MN 56002 |
| Apple Valley
1668
Apple Valley, MN 56105 | Chaska
2830
Chaska, MN 56002 | Chaska
2830
Chaska, MN 56002 | Chaska
2830
Chaska, MN 56002 |

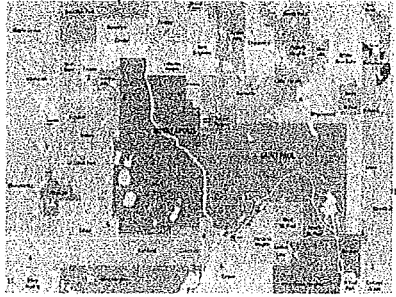
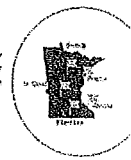

NEW OGILVIE PLAYGROUND

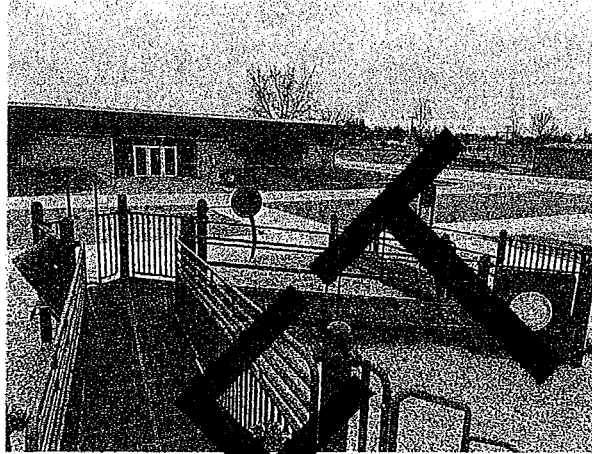

The wood chip ground cover is extremely hard to navigate while pushing a wheelchair and impossible to self propel a wheelchair while on. The playground has a perimeter fence which is vital for elopers.

NEW OGILVIE PLAYGROUND

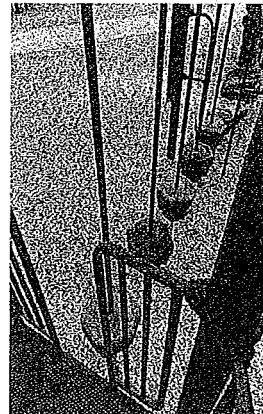

The Ogilvie Playground features a wheelchair ramp but it has nothing for Mikayla to do once she goes up the ramp. Essentially a ramp to "nowhere".

NAVIGATING THE OGILVIE PLAYGROUND

It may be wheelchair accessible but it isn't inclusive.

<https://youtu.be/6cg3vMSPHBo>

<https://youtube.com/shorts/xnNnaX20pic?feature=share>

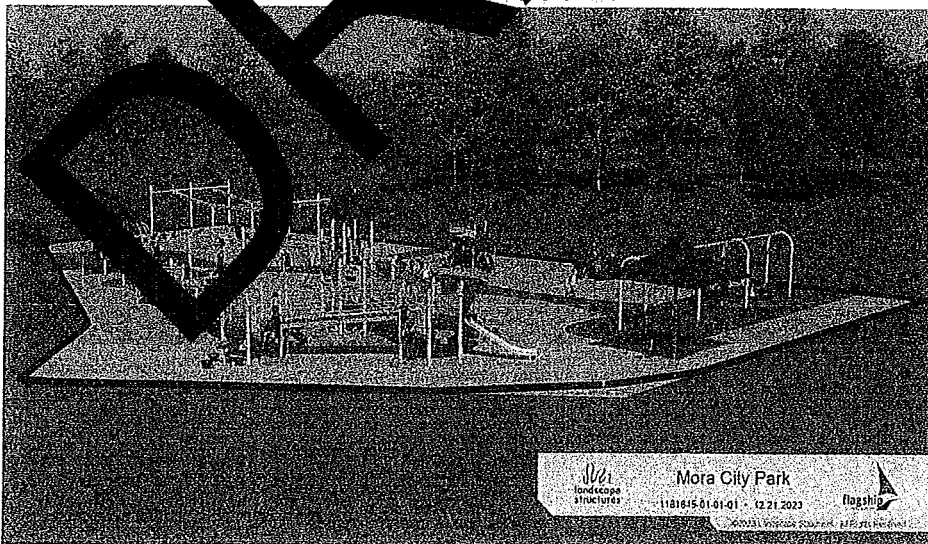

Size:10,000 sq feet, This designs includes concrete border.

MORA PLAYGROUND

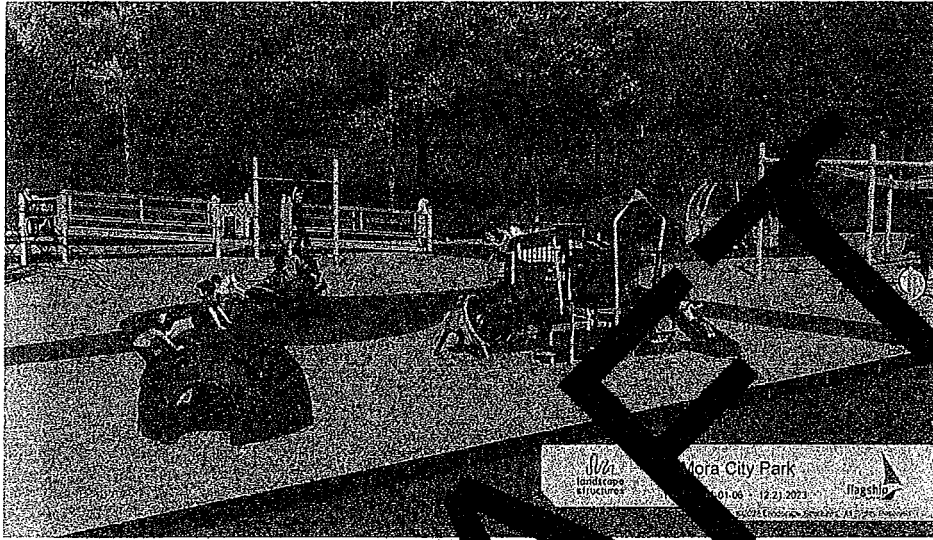

MORA PLAYGROUND

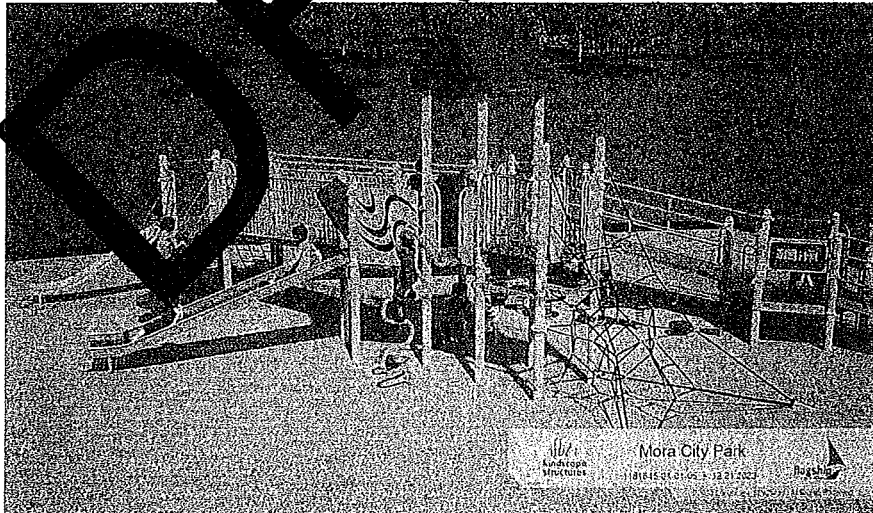

MORA PLAYGROUND

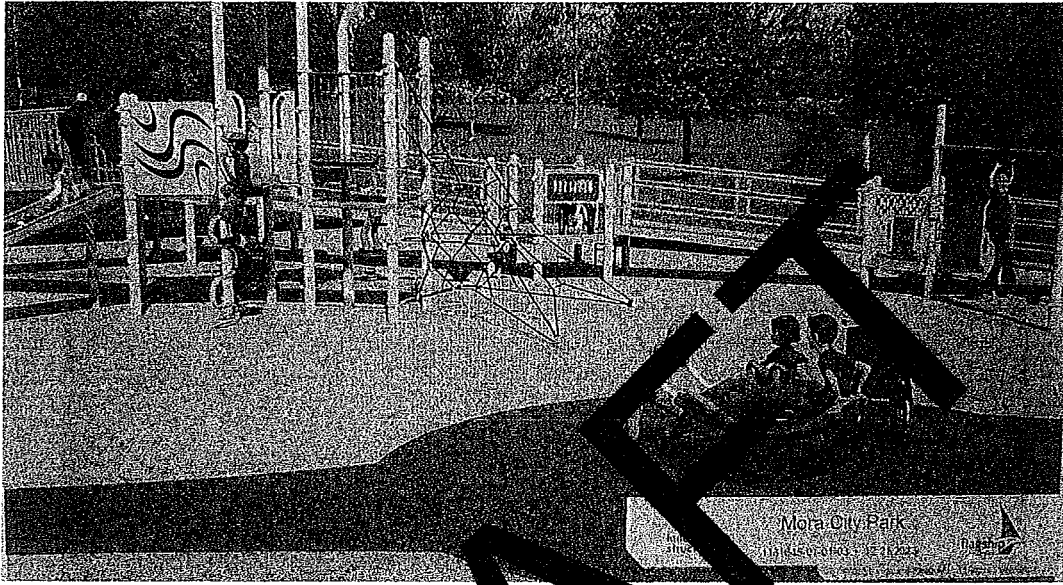

MORA PLAYGROUND



ACCESSIBLE PLAYGROUNDS IN MINNESOTA

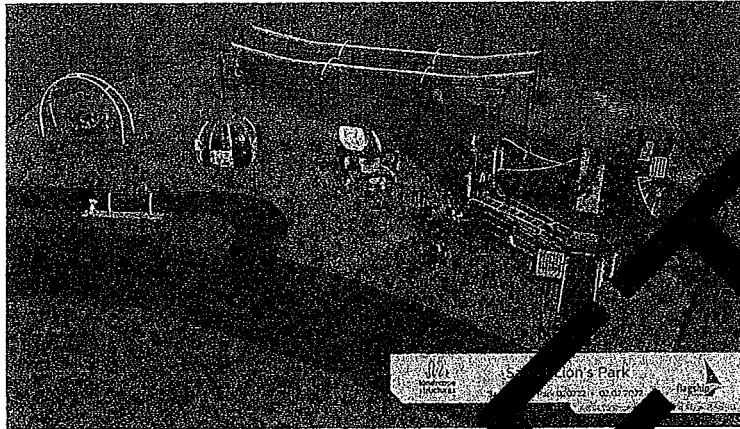

Sartell Lion's Park in Sartell, MN

Cost: \$376,245.80

\$100,000 grant from Lions International

This amount does not include owner provided labor, materials etc

ACCESSIBLE PLAYGROUNDS IN MINNESOTA

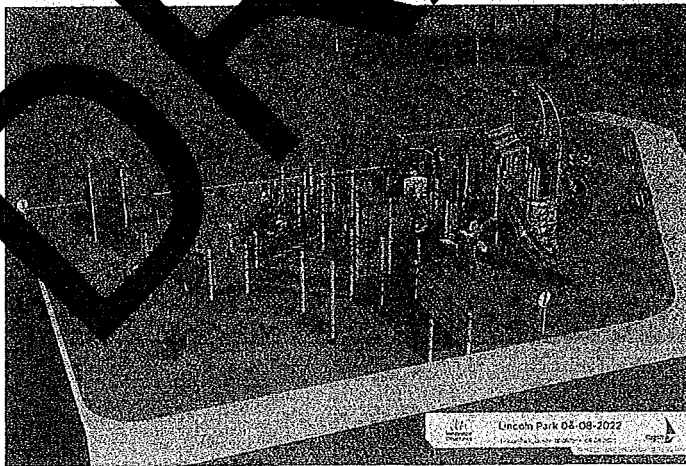

Lincoln Park in Duluth, MN

Cost: \$353,254.40

This amount does not include owner provided labor, materials etc

WHY FENCES ARE CRITICAL

- Installing a fence around your playground makes supervision more efficient, allowing the adult to confine their focus and energy to watching over a smaller area.
- According to MN safety council more than one in five fatal drowning victims are children 14 and younger. For every child who dies from drowning, another four received emergency department care for nonfatal submersion injuries.
- From January 1, 2011 to December 31st, 2016, the National Autism Association collected data on missing person cases in the U.S. involving individuals with an Autism Spectrum Disorder (ASD) who wandered or eloped from a safe setting and were gone long enough to require media and/or police involvement.

Results Out of 808 reported ASD missing person cases of wandering/elopement in the United States from 2011 to 2016, 17% (n = 139) resulted in death. Accidental drowning accounted for 71% of lethal outcomes, followed by 18% caused by traffic injury.

THE MEDICAL MODEL OF DISABILITY VS. THE SOCIAL MODEL OF DISABILITY

Our parks would be so much more for all if we shifted from the medical model of disability to the social model of disability..

Example shown below: an individual utilizing a wheelchair navigating a playground

Within the medical model of disability, the emphasis is placed on the individual who has a disability, rather than the environment surrounding the individual.

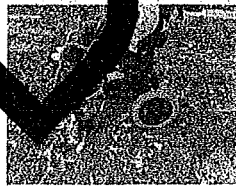

Her inability To Participate in Playground Activities Is Due To Her Inability To Stand And Walk On Pea Gravel

According to the social model of disability, the problem lies with the playground's physical structures and not the individual.

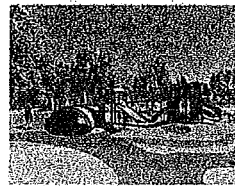

Removing The Pea Gravel And Switching To Poured Ground Cover Would Make The Playground More Accessible.



HOW DO WE MAKE IT A MULTIPURPOSE SPACE?

We would like to think creatively on how the space could be used by multiple groups of people either living in our community or visiting our community.

Some ideas include: Planter boxes for gardening? A little Library? An accessible shelter area with picnic tables for families and field trips? Area for music concerts? Splash pad? Miracle League Baseball field?

WHO BUILDS THE PLAYGROUND?

We are currently working with Tracy a project consultant from Flagship recreation. Flagship recreation is a women owned business and Minnesota based. Flagship Recreation uses equipment from Landscape Structures.

Landscape Structures is a Minnesota based, employee owned company located in Delano, MN. All equipment is tested in Minnesota for at least a year before it is available to the public.

We have discussed the need for an accessible playground with the Mora Park and Recreation board and also Senator Rarick and Representative Nelson.

We are also interested in getting community input on what members of the community would like to see. We are actively looking for a location that has enough space for the playground, a parking lot for accessible vans and hoping to find a location that is not located near water.

HOW ARE WE RAISING AWARENESS?

We are presenting to local stakeholders about the need for the playground and actively networking with individuals that have been successful in building an accessible playground in their area.

We are researching local organizations that may be able to offer monetary help in making the playground a reality.

We have discussed the need for an accessible playground with the Mora Park and Recreation board and also Senator Rarick and Representative Nelson.

We are connected with disability groups if we get the approval to try and secure bonding bill funding to supplement the money we raise.

HOW CAN YOU HELP?

Please spread the word. We have started a Facebook group to share the need for an accessible and inclusive playground.

Offer support. We could use help with planning, fundraising, manual labor, local networking connections.

Contact your local and state representatives to ask for their support in bringing an accessible and inclusive park to our area.

THANK YOU!!

Please contact Elizabeth with any questions
Elizabeth.Jansen43@gmail.com

Please join our facebook group by searching for
Universally Accessible Playground in Moraga

Data Sources

https://mn.gov/admin/assets/minnesotans-with-disabilities-report-march2017_tcm36-26486_tcm36-283045.pdf
<https://www.minnesotasafetycouncil.org/facts/factsheet.cfm?qs=C185789C2856C672&qs2=Minnesota%20Safety%20Council%3A%20ROWNING&text=More%20than%20one%20in%20five%20for%20nonfatal%20injury%20surveys>
<https://adata.org/learn-about-ada>
<https://data.census.gov/table?dsdisab>

DRAFT

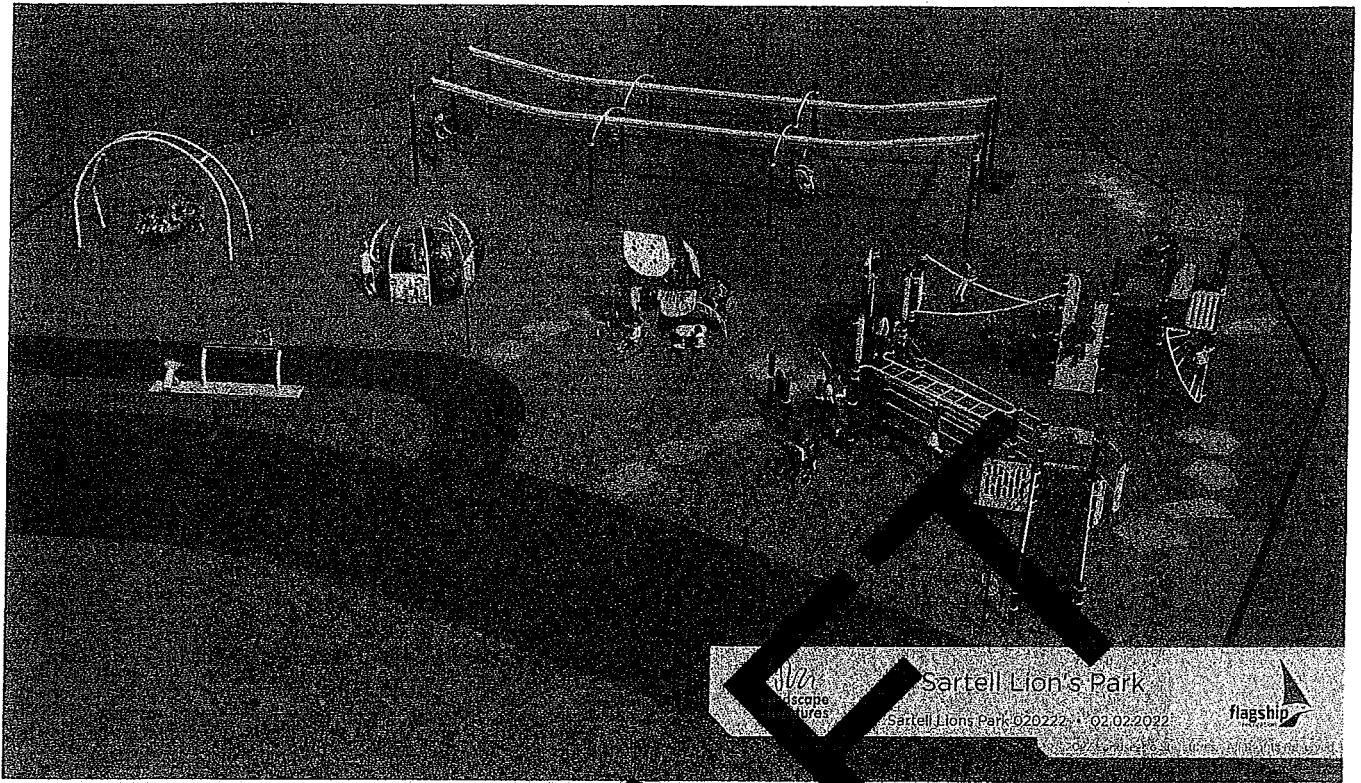

scope lives Sartell Lion's Park
Sartell Lion's Park 020222 • 02.02.2022



DRAFT

© 2022 scope lives. All rights reserved. This document is a draft and should not be used for construction or other purposes without the explicit approval of the design team.

Date 11/1/2022
 Expires 2/19/2023
 Quote: City of Sartell
 Contact: Tony Krueger, Dir Parks & Rec
 Phone: 763-548-4202
 Email: tony.krueger@sartellmn.com



Ship To: Lions Park - Sartell 1013 1st St N Sartell, MN 56377	Please Make PO's & Contracts Out To: Landscape Structures 601 7th St. S Delano, MN 55328
---	--

Bill To: City of Sartell 125 Pinecone Road North Sartell, MN 56377	Please Remit Payment To: Landscape Structures, Inc. SDS 12-0395 PO Box 86 Minneapolis, MN 55486-0395
--	--

We are pleased to submit this proposal to supply the following products/services:

QTY	ITEM #	Description	UNIT PRICE	EXT. PRICE
1	Design	Design - Sartell Lions Park 022022-JT		\$199,909.00
1	Discount	State Contract Discount - 2023 Pricing	8.5%	(\$15,992.72)
<i>Installation and Safety Surfacing on Flagship Recreation Proposal</i>				
<i>Playground "Nature" Colors & Surfacing Design per Render Images Below:</i>				

Subtotal	\$183,916.28
Freight	Flagship Quote
Sales Tax	Tax Exempt Cert
Total	\$183,916.28

Quotes from Landscape Structures, Inc. are subject to current Landscape Structures, Inc. policies as well as Terms & Conditions, Inclusions & Exclusions outlined below unless noted otherwise on this quote. Changes are subject to price adjustment. Sales tax, if applicable, will be applied unless a tax-exempt certificate is provided at the time of order entry. Customer deposits, if required, must be received before orders will be entered & installation scheduled. Purchases in excess of \$1,000.00 must be supported by a formal Purchase Order made out to Landscape Structures, Inc.

Minnesota State Contract #119795

***Terms: Net 30 days; 1.5% finance charge on balances over 30 days**

Terms & Conditions

Contract: Seller's Copy of signed quote represents the contract between Seller and Buyer. This form supersedes all previous communications and negotiations and constitutes the entire agreement between the parties. Any changes to this contract are not binding unless jointly agreed in writing via Change Order.

Project Scope (This Section For Quotes Including Installation)

Inclusions:

- One Mobilization
- Accepting & Unloading of Order Prior to Installation
- Unpacking of Play Equipment
- Assembly of Play Equipment
- Placing, Digging or Surface Mounting Equipment (as specified)
- Concrete for Play Equipment Footings
- Standard Insurance Offer (Detail Provided Upon Request)
- Standard Warranty Offer (Detail Provided Upon Request)
- Standard Wage Rates

Exclusions (Unless Specifically Quoted):

- Storage or Security of Equipment
- Private Utility Locates (irrigation, low voltage, lighting, etc.)
- Additional Labor Due to Site Access. Require 8' Wide Clearance from Staging Area to Play Space.
- Additional Labor and/or Related Costs Due to Subsurface Conditions (Rock, Hardpan, Heavy Clay, Ground Water, etc.)
- Additional Labor and/or Related Costs Due to Working in Unstable Soils (Sand, Silt, Rock, Mud, Poor Site Drainage, etc.)
- Offsite Removal of Spoils From Footing Holes or Other Excavation. Can be stockpiled for owner removal or left in play space
- Disposal of Packing Material. Can be Stockpiled for Owner Removal or Deposited in Owners Onsite Dumpster
- Removal of Existing Play Equipment, Border or Safety Surface Material
- Site Work of Any Kind. Exclusions include, site grading (owner to provide max slope of 1%), site restoration, drainage, etc.
- Border for Play Space
- Bonding of Any Type
- Permits of Any Kind

Force Majeure: In the event performance of this Agreement, or any obligation hereunder, is either directly or indirectly prevented, restricted, or interfered with by reason of fire, flood, tornado or like act of God, wars, civil commotion, explosion, acts of public enemy, embargo, acts of the government, or other difficulties, including without limitation, strikes, slowdowns, picketing, or boycotts, unavailability of equipment from vendor, changes requested by customer, or any other circumstances beyond the reasonable control and without the fault or negligence of Flagship Recreation, Flagship Recreation, upon giving prompt notice to the Customer, shall be excused from such performance on a day-to-day basis to the extent of such prevention, restriction, or interference (and the Customer shall likewise be excused from performance of its obligations on a day-to-day basis until the delay, restriction or interference has ceased); provided however, that Flagship Recreation, shall use diligent efforts to avoid or remove such causes of non-performance and both Parties shall proceed whenever such causes are removed or cease.

Material Cost Escalation: If, during the performance of this contract, the cost of materials significantly increases, through no fault of Flagship Recreation, the price of this contract shall be equitably adjusted by an amount reasonably necessary to cover any such significant increase in the costs of materials. As used herein, a significant cost increase shall mean any increase in cost of materials exceeding 5% experienced by contractor from the date of the contract signing. Such increase in material costs shall be documented through quotes, invoices, or receipts. Where the delivery of materials delayed, through no fault of the contractor, as a result of the shortage or unavailability of the materials, contractor shall not be liable for any additional costs or damages associated with such delay(s).

Acceptance of Quotation:

Accepted By (Print) Tony Krueger, Dir Parks & Rec	PO#:
Signature:	Email: tony.krueger@sartellmn.com
Title:	Phone:
Date:	Purchase Amount: \$183,916.28



Date 11/1/2022
 Expires 2/19/2023
 Quote: City of Sartell
 Contact: Tony Krueger, Dir Parks & Rec
 Phone: 763-548-4202
 Email: tony.krueger@sartellmn.com



Ship To: Lions Park - Sartell 1013 1st St N Sartell, MN 56377	Please Make PO's & Contracts Out To: Flagship Recreation 11123 Upper 33rd St. N Lake Elmo, MN 55042
---	---

Bill To: City of Sartell 125 Pinecone Road North Sartell, MN 56377	Please Remit Payment To: Flagship Recreation 11123 Upper 33rd St. N Lake Elmo, MN 55042
--	---

We are pleased to submit this proposal to supply the following products/services:

QTY	ITEM #	Description	UNIT PRICE	EXT. PRICE
		Design - Sartell Lions Park 022022-JT		
		Playground Equipment on Landscape Structures, Inc Quote		
1	Mob	Mobilization		\$750.00
1	Install	Installation by Landscape Structures Certified Installers		\$27,806.56
1	Per Diem	Lodging/Meals - Invoiced at Cost/No Markup per State Code	Estimated	\$1,775.00
		Dumpster - 30 Yard for Disposal of Pallets, Materials/Pallets, etc	Owner	
		Site Work - Excavation, Demo & Site Grading	Owner	
		Footer Removal/Soil Correction as Needed to Support New Footers		
		Concrete Border - 6"W x 12"D (LF)	Owner	
		Concrete Flatwork - (Sq Ft) Needed	Owner	
		Installed PRIOR to Playground Equipment Installation		
		Class 5 or Replaced Concrete (Sub-base), Installation & Compaction	Owner	
		Drain Tile - 4" Perforated PIP	Owner	
		PIP Base & Drainage Installed AFTER Playground Equipment Installation		
6172	Surfacing	Replaced Concrete (PIP) Surface Surfacing (Sq Ft)		\$155,022.77
		10-Year / Inert / Leading Warranty		
		Chain Link or other Security Fencing	Owner	
		After Hours Security Services/Monitoring (3-4 Days)	Owner	
		Flagship Recreation does Not provide Security Fencing nor is Flagship Recreation licensed/certified to perform Security Services.		
		Damage to property during installation not Warranted		
		Site Restoration (Sq.Ft.) - Backfill Curb, Grass Seed/Straw Blankets	Owner	
			Subtotal	\$185,354.34
			Freight -	
			Actual Cost	\$975.00
			Sales Tax	Tax Exempt Cert
			Total	\$186,329.34

Quotes from Flagship Recreation, are subject to current Landscape Structures, Inc. policies as well as Terms & Conditions, Inclusions & Exclusions outlined below unless noted otherwise on this quote. Changes are subject to price adjustment. Sales tax, if applicable, will be applied unless a tax-exempt certificate is provided at the time of order entry. Customer deposits, if required, must be received before orders will be entered & installation scheduled. Purchases in excess of \$1,000.00 must be supported by a formal Purchase Order made out to Flagship Recreation

Minnesota State Contract #119795

***Terms: Net 30 days; 1.5% finance charge on balances over 30 days**

Terms & Conditions

Contract: Seller's Copy of signed quote represents the contract between Seller and Buyer. This form supersedes all previous communications and negotiations and constitutes the entire agreement between the parties. Any changes to this contract are not binding unless jointly agreed in writing via Change Order.

Project Scope (This Section For Quotes Including Installation)

Inclusions:

- One Mobilization
- Accepting & Unloading of Order Prior to Installation
- Unpacking of Play Equipment
- Assembly of Play Equipment
- Placing, Digging or Surface Mounting Equipment (as specified)
- Concrete for Play Equipment Footings
- Standard Insurance Offer (Detail Provided Upon Request)
- Standard Warranty Offer (Detail Provided Upon Request)
- Standard Wage Rates

Exclusions (Unless Specifically Quoted):

- Storage or Security of Equipment
- Private Utility Locates (irrigation, low voltage, lighting, etc.)
- Additional Labor Due to Site Access. Require 8' Wide Clearance from Staging Area to Play Space.
- Additional Labor and/or Related Costs Due to Subsurface Conditions (Rock, Tree Root, Heavy Clay, Ground Water, etc.)
- Additional Labor and/or Related Costs Due to Working in Unstable Soils (Sand, Fills, Slits, Mud, Poor Site Drainage, etc.)
- Offsite Removal of Spoils From Footing Holes or Other Excavation. Can be stockpiled for owner removal or left in play space
- Disposal of Packing Material. Can be Stockpiled for Owner Removal or Deposited in Owners Onsite Dumpster
- Removal of Existing Play Equipment, Border or Safety Surface Materials
- Site Work of Any Kind. Exclusions include, site grading (owner to provide for a fee of 1%), site restoration, drainage, etc.
- Border for Play Space
- Bonding of Any Type
- Permits of Any Kind

Force Majeure: In the event performance of this Agreement, or any obligation hereunder, is either directly or indirectly prevented, restricted, or interfered with by reason of fire, flood, tornado or like act of God, wars, civil commotion, explosion, acts of public enemy, embargo, acts of the government, labor difficulties, transportation limitation, strikes, slowdowns, picketing, or boycotts, unavailability of equipment from vendor, changes requested by Customer, or any other circumstances beyond the reasonable control and without the fault or negligence of Flagship Recreation, Flagship Recreation, upon giving prompt notice to the Customer, shall be excused from such performance on a day-to-day basis to the extent of such prevention, restriction, or interference (and the Customer shall likewise be excused from performance of its obligations on a day-to-day basis until the delay, restriction or interference has ceased); provided however, that Flagship Recreation so excused shall use diligent efforts to avoid or remove such causes of non-performance and both Parties shall proceed whenever such causes are removed or cease.

Material Cost Escalation: If, during the performance of this contract, the cost of materials significantly increases, through no fault of Flagship Recreation, the price of this contract shall be equitably adjusted by an amount reasonably necessary to cover any such significant increase in the costs of materials. As used herein, a significant cost increase shall mean any increase in cost of materials exceeding 5% experienced by contractor from the date of the contract signing. Such increase in material costs shall be documented through quotes, invoices, or receipts. Where the delivery of materials delayed, through no fault of the contractor, as a result of the shortage or unavailability of the materials, contractor shall not be liable for any additional costs or damages associated with such delay(s).

Acceptance of Quotation:

Accepted By (Print) Tony Krueger, Dir Parks & Rec	PO#:
Signature:	Email: tony.krueger@sartellmn.com
Title:	Phone:
Date:	Purchase Amount: \$186,329.34



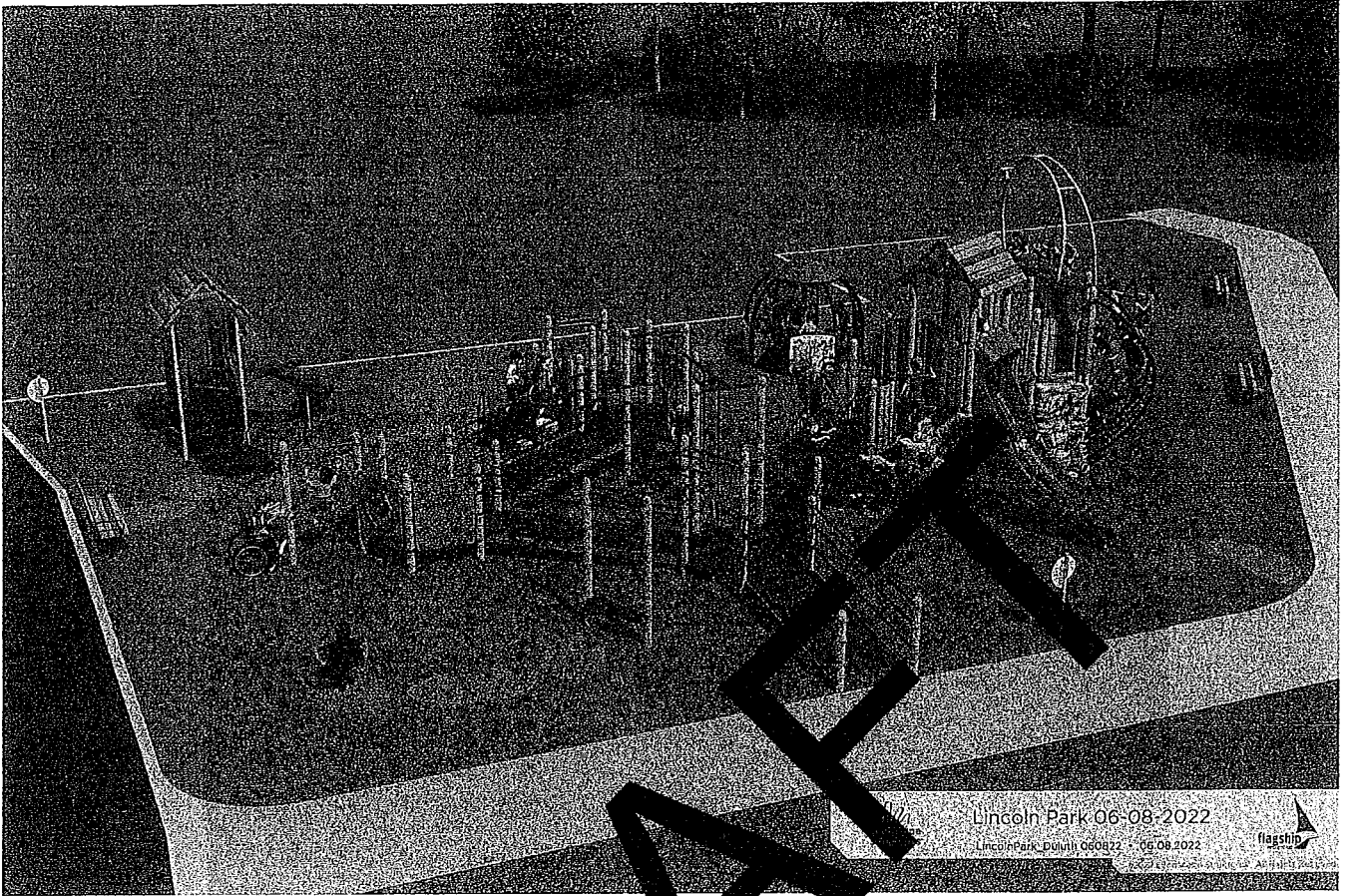

DRAFT

Lincoln Park 06-08-2022

Lincoln Park - Duval County 06-08-2022





FLAGSHIP RECREATION
 17125 UPPER 33RD. ST N
 LAKE MINNETONKA, MN 55042
 763-550-7860
 FLAGSHIPPLAY.COM
 @FLAGSHIPPLAY



THIS PLAN AREA & DIMENSIONS ARE
 DESIGNED FOR RANGE RANGES AS NOTED
 ON PLAN.

LINCOLN PARK
 Revised Design
 25th Avenue West & 5th Street
 Duluth, MN

SALES
 REPRESENTATIVE:
 Stacy Strand

DESIGNED BY:
 JLT
 06/08/2022

3/16" = 1'-0"

SHEET
LS101

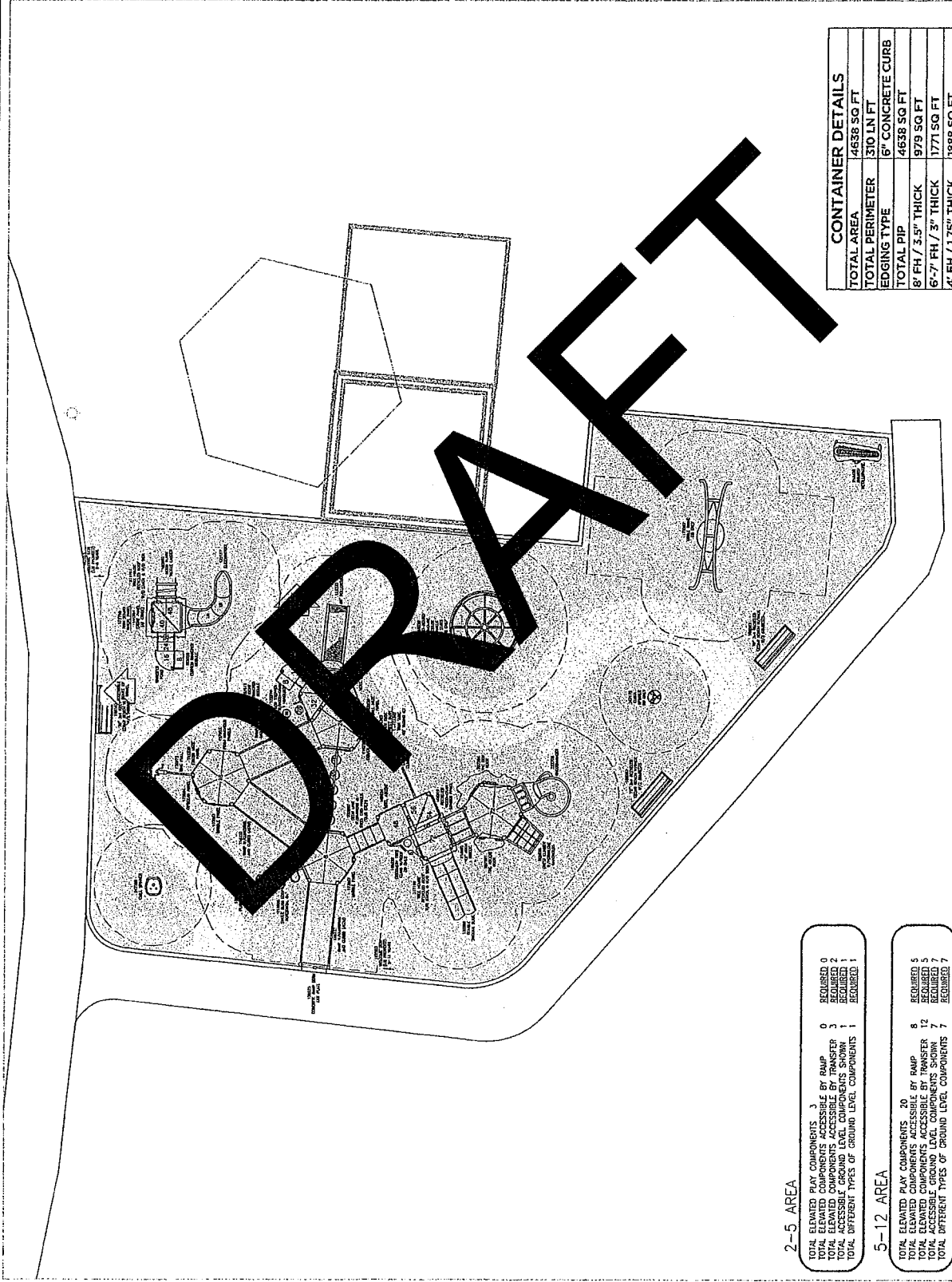

CONTAINER DETAILS	
TOTAL AREA	4638 SQ FT
TOTAL PERIMETER	310 LN FT
EDGING TYPE	6" CONCRETE CURB
TOTAL PIP	4638 SQ FT
8' FH / 3.5" THICK	979 SQ FT
6'-7" FH / 3" THICK	1771 SQ FT
4' FH / 1.75" THICK	1888 SQ FT

2-5 AREA

TOTAL ELEVATED PLAY COMPONENTS 3
 TOTAL ELEVATED COMPONENTS ACCESSIBLE BY RAMP 0
 TOTAL ELEVATED COMPONENTS ACCESSIBLE BY TRANSFER 3
 TOTAL DIFFERENT TYPES OF GROUND LEVEL COMPONENTS 1
 TOTAL DIFFERENT TYPES OF GROUND LEVEL COMPONENTS 1

5-12 AREA

TOTAL ELEVATED PLAY COMPONENTS 20
 TOTAL ELEVATED COMPONENTS ACCESSIBLE BY RAMP 8
 TOTAL ELEVATED COMPONENTS ACCESSIBLE BY TRANSFER 12
 TOTAL DIFFERENT TYPES OF GROUND LEVEL COMPONENTS SHOWN 7
 TOTAL DIFFERENT TYPES OF GROUND LEVEL COMPONENTS 7

Date: 7/7/2022
 Expires: 7/21/2022
 Quote: City of Duluth
 Contact: Jessica Peterson, Dir Parks & Rec
 Phone: 218-730-4309
 Email: jpeterson@duluthmn.gov



Ship To: Lincoln Park 25th Avenue West & 5th Street Duluth, MN 55806	Please Make PO's & Contracts Out To: Landscape Structures 601 7th St. S Delano, MN 55328
--	--

Bill To: City of Duluth 411 W 1st Street Duluth, MN 55802	Please Remit Payment To: Landscape Structures, Inc. SDS 12-0395 PO Box 86 Minneapolis, MN 55486-0395
---	--

We are pleased to submit this proposal to supply the following products/services:

QTY	ITEM #	Description	UNIT PRICE	EXT. PRICE
1	Play Equip	Design - LincolnPark_Duluth 061522-JT		\$223,069.00
1	Discount	State Contract Discount	8.00%	(\$17,845.52)
		<i>Playground Equipment ONLY - Install, Surfacing on Flagstone Quote</i>		
		<i>Playground Nature Color Palette & Poured-in-Place Design per drawing below:</i>		
		<small>Lincoln Park 06-08-2022</small>		
1	Bond	Payment Bond 1.5% per State Contract - No Markup	1.50%	\$3,078.00
			Subtotal	\$208,301.48
			Freight	\$1,650.00
			Sales Tax	Tax Exempt Cert
			Total	\$209,951.48

Quotes from Landscape Structures, Inc. are subject to current Landscape Structures, Inc. policies as well as Terms & Conditions, Inclusions & Exclusions outlined below unless noted otherwise on this quote. Changes are subject to price adjustment. Sales tax, if applicable, will be applied unless a tax-exempt certificate is provided at the time of order entry. Customer deposits, if required, must be received before orders will be entered & installation scheduled. Purchases in excess of \$1,000.00 must be supported by a formal Purchase Order made out to Landscape Structures, Inc.

Minnesota State Contract #119795
***Terms: Net 30 days; 1.5% finance charge on balances over 30 days**
 Page 1 of 2

Terms & Conditions

Contract: Seller's Copy of signed quote represents the contract between Seller and Buyer. This form supersedes all previous communications and negotiations and constitutes the entire agreement between the parties. Any changes to this contract are not binding unless jointly agreed in writing via Change Order.

Project Scope (This Section For Quotes Including Installation)

Inclusions:

- One Mobilization
- Accepting & Unloading of Order Prior to Installation
- Unpacking of Play Equipment
- Assembly of Play Equipment
- Placing, Digging or Surface Mounting Equipment (as specified)
- Concrete for Play Equipment Footings
- Standard Insurance Offer (Detail Provided Upon Request)
- Standard Warranty Offer (Detail Provided Upon Request)
- Standard Wage Rates

Exclusions (Unless Specifically Quoted):

- Storage or Security of Equipment
- Private Utility Locates (Irrigation, low voltage, lighting, etc.)
- Additional Labor Due to Site Access. Require 8' Wide Clearance from Staging Area to Play Space.
- Additional Labor and/or Related Costs Due to Subsurface Conditions (Rock Hardpan, Heavy Clay, Ground Water, etc.)
- Additional Labor and/or Related Costs Due to Working in Unstable Soils (Sand, Sea Rock, etc., Poor Site Drainage, etc.)
- Offsite Removal of Spoils From Footing Holes or Other Excavation. Can be stockpiled for owner removal or left in play space
- Disposal of Packing Material. Can be Stockpiled for Owner Removal or Deposited in Owners Onsite Dumpster
- Removal of Existing Play Equipment, Border or Safety Surface Material
- Site Work of Any Kind. Exclusions include, site grading (owner to provide max slope of 1:1), site restoration, drainage, etc.
- Border for Play Space
- Bonding of Any Type
- Permits of Any Kind

Force Majeure: In the event performance of this Agreement, or any obligation hereunder, is either directly or indirectly prevented, restricted, or interfered with by reason of fire, flood, tornado or like act of God, wars, civil commotion, explosion, acts of public enemy, embargo, acts of the government, labor difficulties, including without limitation, strikes, slowdowns, picketing, or boycotts, unavailability of equipment from vendor, changes requested by Customer, or any other circumstances beyond the reasonable control and without the fault or negligence of Flagship Recreation, Flagship Recreation, upon giving prompt notice to the Customer, shall be excused from such performance on a day-to-day basis to the extent of such prevention, restriction, or interference (and the Customer shall likewise be excused from performance of its obligations on a day-to-day basis until the delay, restriction or interference has ceased); provided however, that Flagship Recreation, shall use diligent efforts to avoid or remove such causes of non-performance and both Parties shall proceed whenever such causes are removed or cease.

Material Cost Escalation: If, during the performance of this contract, the cost of materials significantly increases, through no fault of Flagship Recreation, the price of this contract shall be equitably adjusted by an amount reasonably necessary to cover any such significant increase in the costs of materials. As used herein, a significant cost increase shall mean any increase in cost of materials exceeding 5% experienced by contractor from the date of the contract signing. Such increase in material costs shall be documented through quotes, invoices, or receipts. Where the delivery of materials delayed, through no fault of the contractor, as a result of the shortage or unavailability of the materials, contractor shall not be liable for any additional costs or damages associated with such delay(s).

Acceptance of Quotation:

Accepted By (Print)	Jessica Peterson, Dir Parks & Rec	PO#:	
Signature:		Email:	jpeterson@duluthmn.gov
Title:		Phone:	
Date:		Purchase Amount:	\$209,951.48



Date 7/7/2022
 Expires 8/6/2022
 Quote: City of Duluth
 Contact: Jessica Peterson, Dir Parks & Rec
 Phone: 218-730-4309
 Email: jpeterson@duluthmn.gov



Ship To: Lincoln Park 25th Avenue West & 5th Street Duluth, MN 55806	Please Make PO's & Contracts Out To: Flagship Recreation 11123 Upper 33rd St. N Lake Elmo, MN 55042
--	---

Bill To: City of Duluth 411 W 1st Street Duluth, MN 55802	Please Remit Payment To: Flagship Recreation 11123 Upper 33rd St. N Lake Elmo, MN 55042
---	---

We are pleased to submit this proposal to supply the following products/services:

QTY	ITEM #	Description	UNIT PRICE	EXT. PRICE
		Design - LincolnPark_Duluth 061522-JT		
		Playground Equip Quote & Discount see LSI Quote		
1	Mobilization	Mobilization		\$500.00
1	Install	Installation by Landscape Structures Certified Installers Prevailing Wages - Site Boring Sample Results Req'd for Design & Install		\$41,963.88
1	Lodging	Per Diem (hotel, meals, etc.) - At Cost - No Markup Per State Contract	Estimated	\$2,100.00
		Dumpster - 30 Yard		\$500.00
		Site Work - Excavation, Demo & Site Grading	General Contractor	
		Concrete Curb Surrounding Retained Edge Sidewalk - Playground Border	General Contractor	
		Class 5 or Replaced Concrete (Base) Material Installation Consult w/ Flagship Recreation for Installation Requirements Soil Compaction Testing Results Req'd Prior to P&P Install	General Contractor	
	Drainage	18" Corrugated Pipe w/ Sock - Inside the Playground Container Per Drainage Plans / Tie In to Curb/Sidewalk	General Contractor	
4638	Surface	Poured In Place (P&P) Sq Ft Industry Leading 10 Year Warranty		\$96,121.04
	Security	Security During P&P Install 24/7 for 3-4 Days Damage during installation not Warranted	Other	
		Site Restoration (Sq.Ft.) - Backfill Curb/Seed/Straw Blanket, etc.	General Contractor	
1	Bond	Payment & Performance Bond 1.5% Per State Contract - No Markup	1.50%	\$2,118.00
			Subtotal	\$143,302.92
			Freight	Equipment Quote
			Sales Tax	Tax Exempt Cert
			Total	\$143,302.92

Quotes from Flagship Recreation. are subject to current Landscape Structures, Inc. policies as well as Terms & Conditions, Inclusions & Exclusions outlined below unless noted otherwise on this quote. Changes are subject to price adjustment. Sales tax, if applicable, will be applied unless a tax-exempt certificate is provided at the time of order entry. Customer deposits, if required, must be received before orders will be entered & installation scheduled. Purchases in excess of \$1,000.00 must be supported by a formal Purchase Order made out to Flagship Recreation

Minnesota State Contract #119795

*Terms: Net 30 days; 1.5% finance charge on balances over 30 days

Terms & Conditions

Contract: Seller's Copy of signed quote represents the contract between Seller and Buyer. This form supersedes all previous communications and negotiations and constitutes the entire agreement between the parties. Any changes to this contract are not binding unless jointly agreed in writing via Change Order.

Project Scope (This Section For Quotes Including Installation)

Inclusions:

- One Mobilization
- Accepting & Unloading of Order Prior to Installation
- Unpacking of Play Equipment
- Assembly of Play Equipment
- Placing, Digging or Surface Mounting Equipment (as specified)
- Concrete for Play Equipment Footings
- Standard Insurance Offer (Detail Provided Upon Request)
- Standard Warranty Offer (Detail Provided Upon Request)
- Standard Wage Rates

Exclusions (Unless Specifically Quoted):

- Storage or Security of Equipment
- Private Utility Locates (irrigation, low voltage, lighting, etc.)
- Additional Labor Due to Site Access. Require 8' Wide Clearance from Staging Area to Play Space.
- Additional Labor and/or Related Costs Due to Subsurface Conditions (Rock, Hardpan, Heavy Clay, Ground Water, etc.)
- Additional Labor and/or Related Costs Due to Working in Unstable Soils (Sand, Loose Soil, Mud, Poor Site Drainage, etc.)
- Offsite Removal of Spoils From Footing Holes or Other Excavation. Can be stockpiled for owner removal or left in play space
- Disposal of Packing Material. Can be Stockpiled for Owner Removal or Deposited in Owner's Onsite Dumpster
- Removal of Existing Play Equipment, Border or Safety Surface Materials
- Site Work of Any Kind. Exclusions include, site grading (owner to provide max slope of 1%), site restoration, drainage, etc.
- Border for Play Space
- Bonding of Any Type
- Permits of Any Kind

Force Majeure: In the event performance of this Agreement, or any obligation hereunder, is either directly or indirectly prevented, restricted, or interfered with by reason of fire, flood, tornado or like act of God, wars, civil commotion, explosion, acts of public enemy, embargo, acts of the government, labor difficulties, including work stoppage, limitation, strikes, slowdowns, picketing, or boycotts, unavailability of equipment from vendor, changes requested by customer, or any other circumstances beyond the reasonable control and without the fault or negligence of Flagship Recreation, upon giving prompt notice to the Customer, shall be excused from such performance on a day-to-day basis to the extent of such prevention, restriction, or interference (and the Customer shall likewise be excused from performance of its obligations on a day-to-day basis until the delay, restriction or interference has ceased); provided however, that Flagship Recreation so excused shall make diligent efforts to avoid or remove such causes of non-performance and both Parties shall proceed whenever such causes are removed or cease.

Material Cost Escalation: If, during the performance of this contract, the cost of materials significantly increases, through no fault of Flagship Recreation, the price of this contract shall be equitably adjusted by an amount reasonably necessary to cover any such significant increase in the costs of materials. As used herein, a significant cost increase shall mean any increase in cost of materials exceeding 5% experienced by contractor from the date of the contract signing. Such increase in material costs shall be documented through quotes, invoices, or receipts. Where the delivery of materials delayed, through no fault of the contractor, as a result of the shortage or unavailability of the materials, contractor shall not be liable for any additional costs or damages associated with such delay(s).

Acceptance of Quotation:

Accepted By (Print)	Jessica Peterson, Dir Parks & Rec	PO#:	
Signature:		Email:	jpeterson@duluthmn.gov
Title:		Phone:	
Date:		Purchase Amount:	\$143,302.92

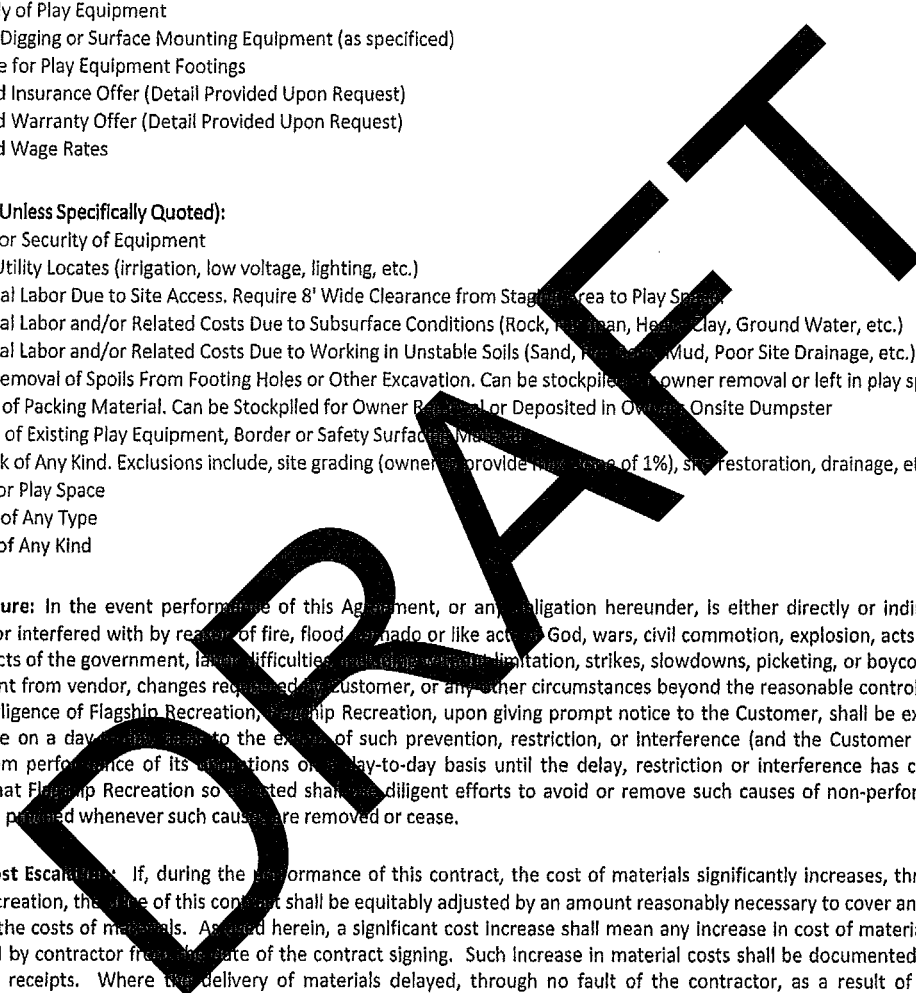

DRAFT



Mora Inclusive Playground

Mora_Inclusive 011024 • 1.12.2024



© 2024 Landscape Structures. All Rights Reserved

DRAFT



SLR
landscape
structures

Mora Inclusive Playground

Mora_Inclusive 011024 • 1.12.2024

flagship
recreation

© 2024 Landscape Structures. All Rights Reserved

DRAFT

CONTAINER DETAILS

TOTAL CONTAINER AREA	10,046 SF
ASTM SAFETY SURFACING TYPE	ENGINEERED WOOD FIBER & PIP
TOTAL PIP AREA	2890 SF
TOTAL EWF AREA	7156 SF
TOTAL PERIMETER	412 LF
EDGING TYPE	4" PLASTIC TIMBERS
FINISH GRADE	TOP OF RAMP ENTRANCE

- ***SITE PREPARATION REQUIREMENTS:
- MAXIMUM OF 1% GRADE CHANGE ACROSS CONTAINER
 - NO PRE-INSTALLED DRAIN TILE OUTSIDE OF 4 FEET OF PERIMETER
 - DRAIN TILE STUB TO BE PROVIDED IF DRAIN TILE IS REQUIRED
 - NO DRAINAGE AGGREGATE PRE-INSTALLED
 - NO FABRIC PRE-INSTALLED
 - MINIMUM CONTAINER SIZE NEEDED DENOTES THE INSIDE OF CURB DIMENSION



FLAGSHIP RECREATION
1123 UPPER 33RD ST N
LAKE ELMO, MN 55082
763-550-7860
FLAGSHIPPLAY.COM
@FLAGSHIPPLAY



Mora Inclusive Playground
230 W Maple Ave, Mora, MN 55051

SALES REPRESENTATIVE:
Stacy Strand

DESIGNED BY:
JLZT
1/12/24

1/8" = 1'-0"

LS101

SHEET

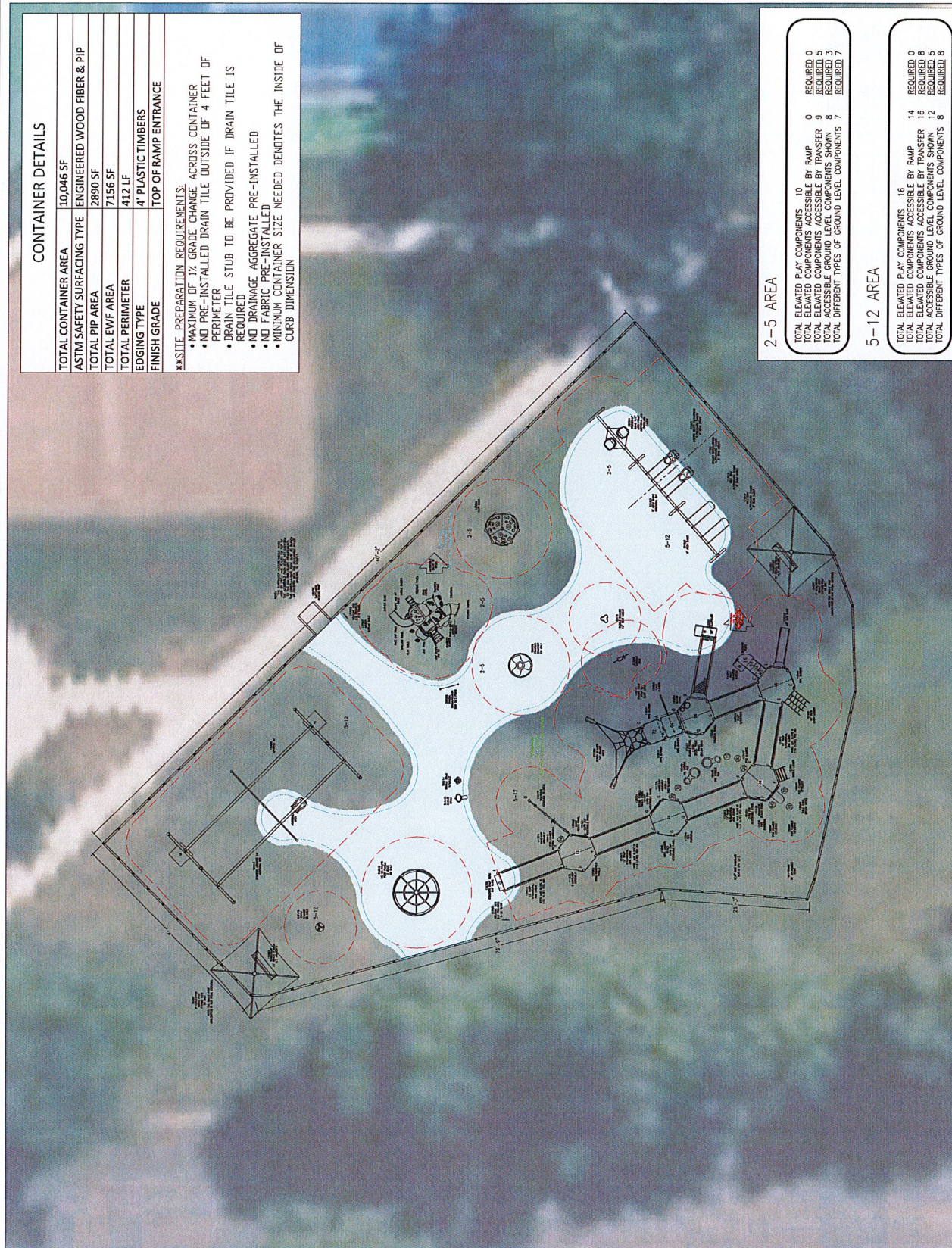

2-5 AREA

- TOTAL ELEVATED PLAY COMPONENTS 10 REQUIRED 0
- TOTAL ELEVATED COMPONENTS ACCESSIBLE BY RAMP 0 REQUIRED 0
- TOTAL ELEVATED COMPONENTS ACCESSIBLE BY TRANSFER 9 REQUIRED 5
- TOTAL ACCESSIBLE GROUND LEVEL COMPONENTS SHOWN 8 REQUIRED 3
- TOTAL DIFFERENT TYPES OF GROUND LEVEL COMPONENTS 7 REQUIRED 7

5-12 AREA

- TOTAL ELEVATED PLAY COMPONENTS 16 REQUIRED 0
- TOTAL ELEVATED COMPONENTS ACCESSIBLE BY RAMP 14 REQUIRED 0
- TOTAL ELEVATED COMPONENTS ACCESSIBLE BY TRANSFER 6 REQUIRED 8
- TOTAL ACCESSIBLE GROUND LEVEL COMPONENTS SHOWN 12 REQUIRED 8
- TOTAL DIFFERENT TYPES OF GROUND LEVEL COMPONENTS 8 REQUIRED 8

DRAFT

POURED-IN-PLACE DETAILS

TOTAL AREA	10,046 SF
PIP BY CRITICAL FALL HEIGHTS	
4' CFH PIP	1728 SF
8' CFH PIP	992 SF
9' CFH PIP	170 SF
TOTAL PIP	2890 SF



FLAGSHIP RECREATION
 11123 UPPER 33RD ST N
 LAKE ELMO, MN 55082
 763-550-7860
 FLAGSHIPPLAY.COM
 @FLAGSHIPPLAY



THIS PLAY AREA & PLAY EQUIPMENT IS
 DESIGNED FOR AGE RANGES AS NOTED
 ON PLAN.

Mora Inclusive Playground
 & SAFETY SURFACING
 230 W Maple Ave, Mora, MN 55051

SALES REPRESENTATIVE:
 Stacy Strand

DESIGNED BY:
 JLZT
 1/12/24

1/8" = 1'-0"

SHEET
 LG101

DRAFT

State Contract #218091



PROJECT INFORMATION

Project name Mora Park Playground
 Address 200 Maple Ave W
 City, State ZIP Mora, MN 55051
 Contract Year 2024

EQUIPMENT INFORMATION & PRICING

Qty	Item No.	Description	Price	Ext Price
MORA INCLUSIVE 5-12				
1	120325A	Ramp Berm Exit Plate Concrete Wall	\$ 536.00	\$ 536.00
1	156233A	Ramp w/Barriers	\$ 6,839.00	\$ 6,839.00
4	174815A	12' Ramp w/Guardrails and Curbs	\$ 9,098.00	\$ 36,392.00
1	193173A	TightRope Bridge w/Grab Bar Attached to Deck	\$ 2,433.00	\$ 2,433.00
1	116249A	Vertical Ladder 24"Dk DB	\$ 995.00	\$ 995.00
1	123284B	Wiggle Ladder 40"Dk DB	\$ 928.00	\$ 928.00
1	153350B	Chain Ladder 48"Dk DB	\$ 1,285.00	\$ 1,285.00
1	156915A	Pod Climber 16"Dk DB Left Mounted Handhold	\$ 663.00	\$ 663.00
1	156916A	Pod Climber No Handsupports 24"Dk DB Right Mounted Har	\$ 1,071.00	\$ 1,071.00
1	157427A	Pod Climber No Handsupports 40"Dk DB	\$ 1,744.00	\$ 1,744.00
1	176080A	Logo Climber 64"Dk DB	\$ 1,923.00	\$ 1,923.00
1	272368A	Zenith Climber w/Permalene Handholds Attached to Square	\$ 7,686.00	\$ 7,686.00
2	111228A	Square Tenderdeck	\$ 1,341.00	\$ 2,682.00
2	121948A	Kick Plate 8"Rise	\$ 148.00	\$ 296.00
1	152911C	Curved Transfer Module Right 48"Dk DB	\$ 3,805.00	\$ 3,805.00
5	178710A	Hexagon Tenderdeck	\$ 3,830.00	\$ 19,150.00
1	115223A	Bubble Panel Above Deck	\$ 1,107.00	\$ 1,107.00
1	115254A	Storefront Panel	\$ 816.00	\$ 816.00
4	116244A	Pipe Barrier Above Deck	\$ 816.00	\$ 3,264.00
2	116245A	Pipe Guardrail Above Deck	\$ 663.00	\$ 1,326.00
1	127439A	Navigator Reach Panel Above Deck	\$ 903.00	\$ 903.00
1	127953A	Handhold Panel Set	\$ 362.00	\$ 362.00
1	129043A	Image Reach Panel Above Deck	\$ 1,199.00	\$ 1,199.00
1	130565A	Table Panel DB	\$ 1,423.00	\$ 1,423.00
1	135731A	Chimes Reach Panel Above Deck	\$ 1,678.00	\$ 1,678.00
1	164092A	Bongo Panel Above Deck	\$ 1,295.00	\$ 1,295.00
1	173565A	Xylofun Panel Above Deck	\$ 3,279.00	\$ 3,279.00
4	191031A	Accessible Panel Curb	\$ 143.00	\$ 572.00
4	111275A	Handloop Assembly	\$ 311.00	\$ 1,244.00
2	111403V	190"Steel Post For Roof DB	\$ 571.00	\$ 1,142.00
2	111403A	182"Alum Post For Roof DB	\$ 576.00	\$ 1,152.00
2	111404X	164"Steel Post DB	\$ 561.00	\$ 1,122.00
2	111404J	76"Alum Post DB	\$ 337.00	\$ 674.00
5	111404H	92"Alum Post DB	\$ 362.00	\$ 1,810.00
6	111404G	100"Alum Post DB	\$ 383.00	\$ 2,298.00
6	111404E	116"Alum Post DB	\$ 403.00	\$ 2,418.00
6	111404D	124"Alum Post DB	\$ 464.00	\$ 2,784.00
6	111404C	132"Alum Post DB	\$ 485.00	\$ 2,910.00
1	118110A	Square Poly Roof Custom Logo Panels	\$ 1,683.00	\$ 1,683.00
1	123333B	Rollerslide 56"Dk DB	\$ 12,393.00	\$ 12,393.00
1	123340B	S/S 18"Wide Slide 48"Dk DB	\$ 3,550.00	\$ 3,550.00
3	158997A	Pod Climber 10" DB	\$ 362.00	\$ 1,086.00
1	152179A	Saddle Spinner DB 16"Height	\$ 1,331.00	\$ 1,331.00
2	158105A	Wobble Pod DB Only	\$ 1,999.00	\$ 3,998.00
1	194663A	ZipKrooz 34' w/Aluminum Posts DB	\$ 15,530.00	\$ 15,530.00
1	196213A	ZipKrooz Assisted Additional Bay 34' w/Aluminum Posts DB	\$ 13,423.00	\$ 13,423.00
1	233059B	DigiRider Bear DB	\$ 1,785.00	\$ 1,785.00
1	247179A	Curva Spinner DB Only	\$ 2,443.00	\$ 2,443.00
1	248819A	We-Go-Round w/Perf Panels - 2 seats DB Only	\$ 38,056.00	\$ 38,056.00
1	214443A	Rhapsody Goblet Drum DB	\$ 1,913.00	\$ 1,913.00
1	253114A	Rhapsody Tongue Drum w/Mallet DB	\$ 3,596.00	\$ 3,596.00
2	154397A	CoolToppers Single Post Pyramid (12'x12') DB Only	\$ 5,151.00	\$ 10,302.00
1	182503C	Welcome Sign (LSI Provided) Ages 5-12 years Direct Bury	\$ -	\$ -
2	141683K	72" TenderTuff Bench w/Back Two Armrests DB	\$ 1,107.00	\$ 2,214.00
2	174018A	Belt Seat ProGuard Chains for 8' Beam Height	\$ 163.00	\$ 326.00
1	177351A	Molded Bucket Seat (5-12 yrs) w/Harness ProGuard Chains f	\$ 1,112.00	\$ 1,112.00

DRAFT

1	218671C	Molded Bucket Seat (2-5 yrs) w/Harness ProGuard Chains fo	\$ 1,112.00	\$ 1,112.00	
1	221292A	5" Arch Swing Frame 8' Beam Height Only	\$ 3,738.00	\$ 3,738.00	
1	221293A	5" Arch Swing Frame Additional Bay 8' Beam Height Only	\$ 2,275.00	\$ 2,275.00	
1	237294A	Friendship Swing w/5" Arch Frame Additional Bay ProGuard	\$ 4,697.00	\$ 4,697.00	
CUSTOM:					
1	CP022364	DTR PB LH Transition Bench for Rollerslide Exit	\$ 2,596.00	\$ 2,596.00	2545 2595.9
		Total		\$ 252,365.00	
		MORA INCLUSIVE 2-5			
1	197057C	Motion w/Play Table DB	\$ 22,282.00	\$ 22,282.00	
1	295696A	ReviRock Bouncer DB Only	\$ 5,661.00	\$ 5,661.00	
1	168099A	Cozy Dome DB	\$ 5,778.00	\$ 5,778.00	
1	182503A	Welcome Sign (LSI Provided) Ages 2-5 years Direct Bury	\$ -	\$ -	
1	298208A	Symbol Communication Sign w/2 Posts DB	\$ 2,137.00	\$ 2,137.00	
		Total		\$ 35,858.00	
		Total Equipment Price		\$ 288,223.00	



Mora Inclusive Playground
 200 Maple Ave W
 Mora, MN 55051
 Elizabeth Marsh, Organizer

DRAFT

BUDGET SHEET

	Preliminary Budget	Possible Additions	Possible Reductions	QTY	Notes
Play Equipment					
Mora Inclusive Playground - 011024 - PIP Paths/Wood Fiber	288,223.00				2024 List Price of Equipment
State of MN Contract Discount	(23,057.84)			8%	State of MN Contract #218091
Sales Tax - if applicable	0.00				ST3 Certificate of Exemption must be provided by owner.
Delivery of Play equipment	1,450.00				At Cost - No Markup - No Shipping & Handling Charges per State Contract
Mobilization	750.00				Transport of Construction Equip to Jobsite by Installation Crew
Dumpster(s) - 30 Yard	1,500.00		(1,500.00)		Disposal of packaging material - Deduct this Amount if Provided by District/Owner
Per Diem (Lodging & Meals for Installation Crew)	2,250.00				Invoiced at Cost - No Markups - Estimated - Weather Delays could increase Costs Slightly
Site work					
Excavation (new container)^Includes Concrete Curb Forms Sq	16,671.47		(16,671.47)	10,300	Excavation of New Play Container to 12" - Deduct this Amount if Provided by Owner
Hauling of Excavated Material (CY)	8,408.90		(8,408.90)	382	Trucking Costs to Remove Excavated Materials to Disposal Site - Deduct this Amount if Provided by Owner
Disposal of Excavated Material (CY)	8,408.90		(8,408.90)	382	Cost to dispose of material at approved site - Deduct this Amount if Provided by Owner
Special Equipment (Lull, Lift for Roofs)	2,136.54				Lift Rental for Roof Installations
Border Options					
APS Plastic Timbers & Ramp	6,216.35			105	Materials & Installation
Equipment Installation (Labor & Concrete for Footings)	47,489.35				Full installation by Landscape Structures Certified Installers. Standard labor rate unless otherwise noted
Concrete Flatwork					None
Subgrade Prep & Engineered Wood Fiber Surfacing (EWF)					
Drainage Aggregate - Pea Rock or Concrete Sand (Tons)	9,051.35		(9,051.35)	93	Drainage Agg & Installation - Deduct this Amount if Provided by Owner
GeoTextile Fabric (Sq. Ft.)	3,143.63		(3,143.63)	8,300	Price includes installation - Deduct if Not Needed or if Provided by Owner
Playground Wood Fiber - Safety Surfacing (CY) -Installed-	13,949.65			310	IPEMA Certified Playground Surfacing - Meets the standards of ASTM, ADA & CPSC
Subgrade Prep & Poured In Place (PIP) or Turf Surfacing					
Compacted Aggregate Base (Recycled Concrete or Class 5) (Tons)	10,695.03			113	Class 5 aggregate or recycled concrete (w/fines), delivery and installation . 4" - 6" compacted depth. Required for PIP & Turf installations
Drain Tile (LF)	6,598.67			350	Perforated Corrugated Drain Tile with Sock - Needed for PIP Warranty
PlayBound Poured In Place (PIP) by Surface America (Sq. Ft.)	57,988.81			2,890	Estimated uses Aliphatic Binder (10-Year Warranty) for a 50/50 mix of standard colors & black. 10-Year Warranty is the Industry Leading. Flagship Recreation is also certified for PIP repairs if unexpected damage to small areas occurs.
Chain Link Construction Fence (8' x 8' Panels)	0.00			0	Temporary Construction Fencing / Blocking off Access Routes - Provided by Owner
Security Guard/Site Monitoring by Owner	0.00				Site Security is needed throughout the PIP cure time (minimum of 72 hours after completion of the work) especially in high traffic areas or potential for vandalism. Defects due to trespass before sufficient cure time will not be covered by warranty - Provided by Owner - Discuss Overnight Security Options - Flagship Recreation is NOT Licensed for Security Services.
Site Restoration (Sq.Ft.)	0.00			0	Top soil Correction (Not Replacement), Seed & Straw Blanket & Irrigation/Watering - Provided by Owner
	Budget Total	Total Additions	Total Reductions		Total w/ Additions & Reductions
	461,873.80	0.00	(47,184.25)		414,689.55

Draft

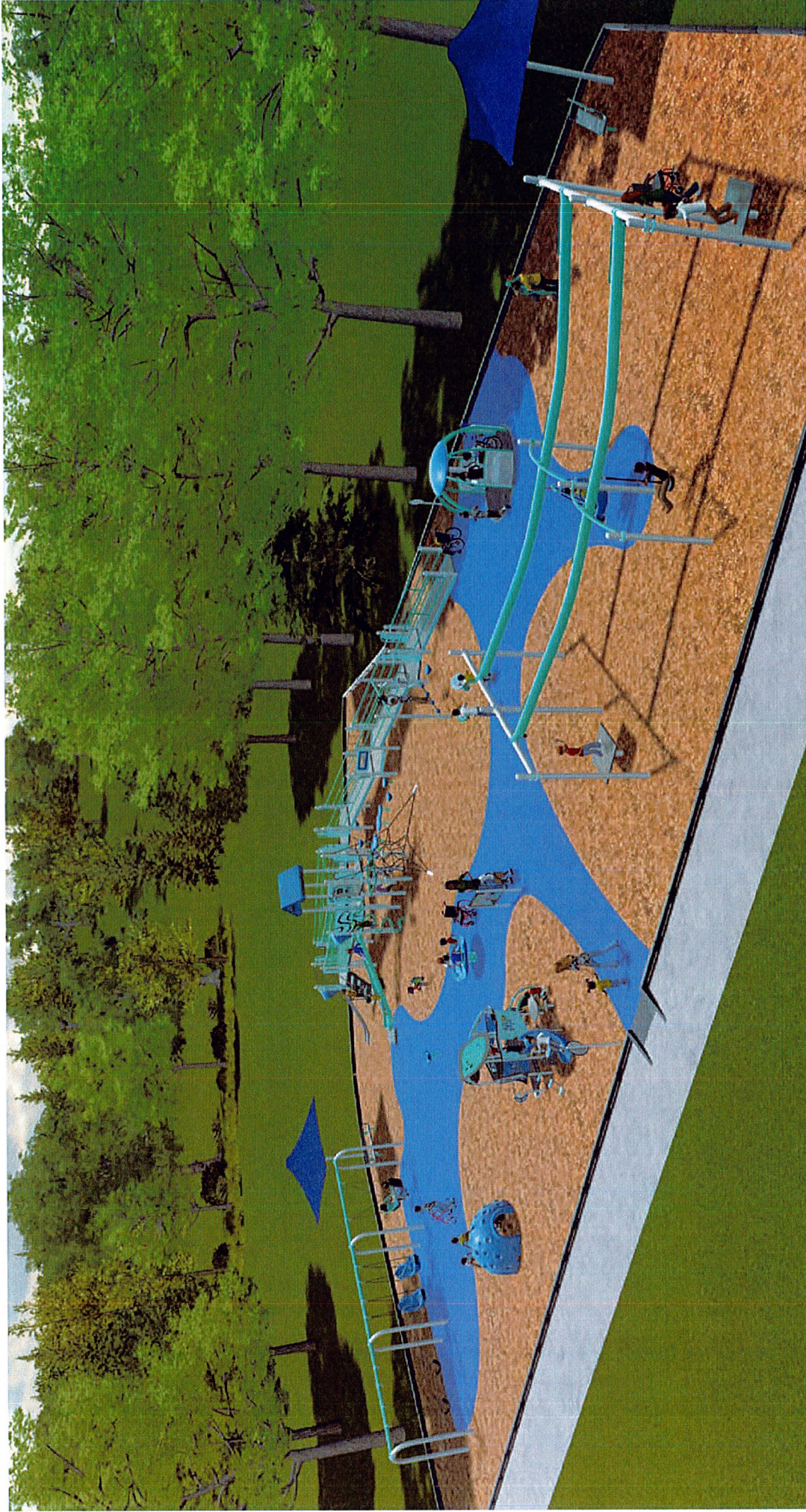

Mora Inclusive Playground

Mora_Inclusive 011024 • 112 2024



© 2024 Landscape Structures. All Rights Reserved